



40/102-108 St. Georges Road Preston, VIC



## Spacious Apartment In A Sensational Spot

Set within the renowned "Pinnacle" building, this wonderful apartment combines a clever and practical design with quality, stylish contemporary finishes. Literally seconds from Preston Station for that quick trip into town for work or play, it is just a short walk to the supermarket, iconic Preston market and eateries on nearby High Street. Quality stainless steel appliances set in polished black stone bench tops feature in a classy kitchen overlooking open plan living area where sliding doors lead to a terrace creating the perfect environment for indoor outdoor relaxation or entertaining. The bedroom opens directly to the two-way designer bathroom with hidden laundry. Extras of lift, undercover parking and security entrance make this fabulous apartment ideal for owner occupiers and investors alike.

**Price:** Sold for \$295,000



**Love Preston**

preston@lovere.com.au

# 40/102-108 St. Georges Rd. Preston

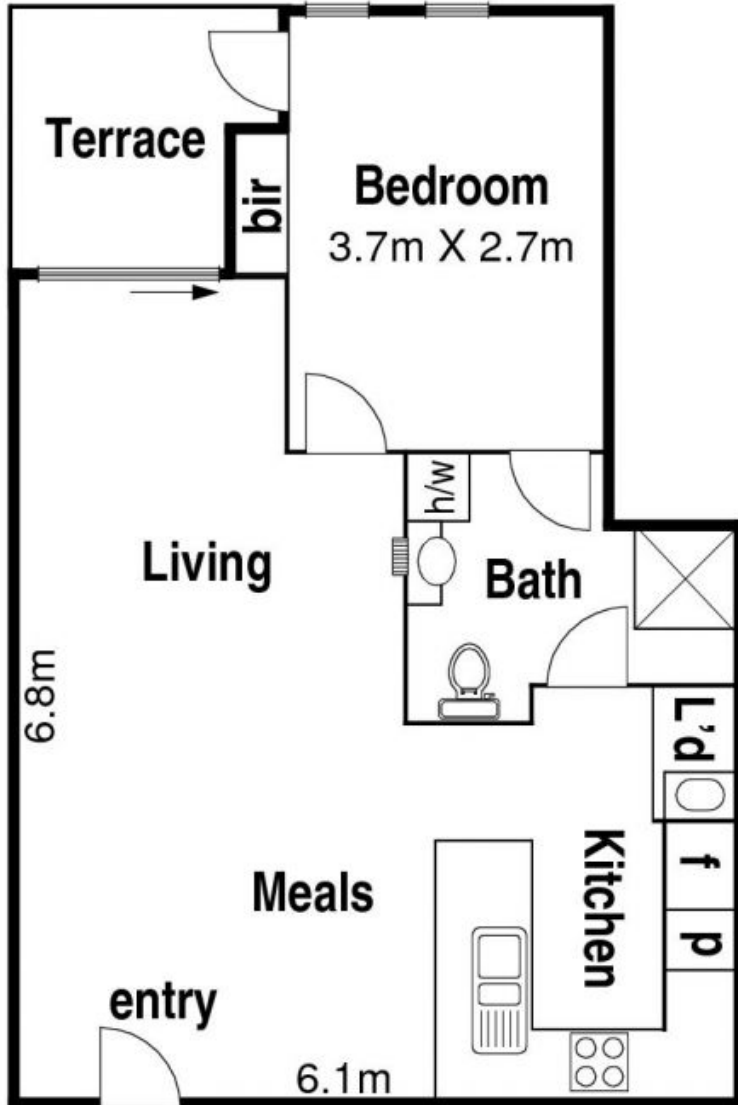

**LOVE & CO**