



46 Webb Street Fitzroy, VIC



### Architectural Award-Winning Townhouse

An award winning design in the eclectic neighbourhood of Fitzroy sets the scene for this Townhouse; designed in cutting-edge contemporary style. The area is synonymous with a trendy lifestyle where Brunswick St, Gertrude St and Smith St bars, restaurants, shops, trams and cafes are at the doorstep.

Making a bold style statement throughout, every detail has been carefully considered from the seamless mirror finish Terrazzo floor and an exterior building fabric which blends with the grunge industrial buildings nearby. The Living areas have bespoke elements including a glass tilt door that opens up onto the first floor Terrace for entertaining. The windows are shugg double sashless which extend full height and there is an arresting play of sunlight which is a recurring theme throughout. There are two downstairs bedrooms with built-in robes which look out onto a light atrium / courtyard.

The first floor area consists of open-plan Living / Dining area which incorporates a Galley Kitchen. The master bedroom is placed on the mezzanine floor and incorporates; Polished hardwood timber floors, Built-in robe, Ensuite with a bath and a Juliet balcony overlooking the streetscape. The ground floor level consists of a; Two car Garage, Single

**Price:** Under Contract



**Graham Love**

0418 534 450  
 graham.l@lovere.com.au



**Michael Love**

0400 106 577  
 loverealstate@mail.inspectreale

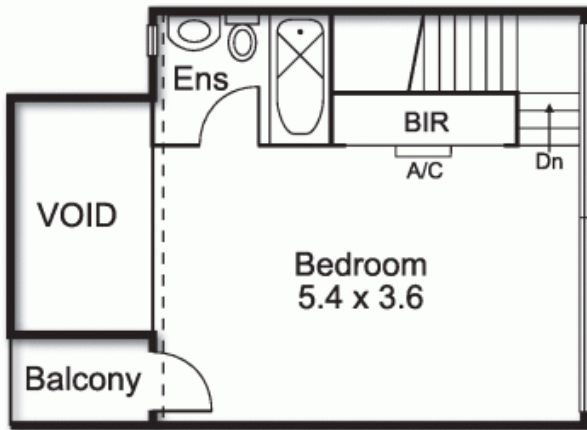

SECOND FLOOR

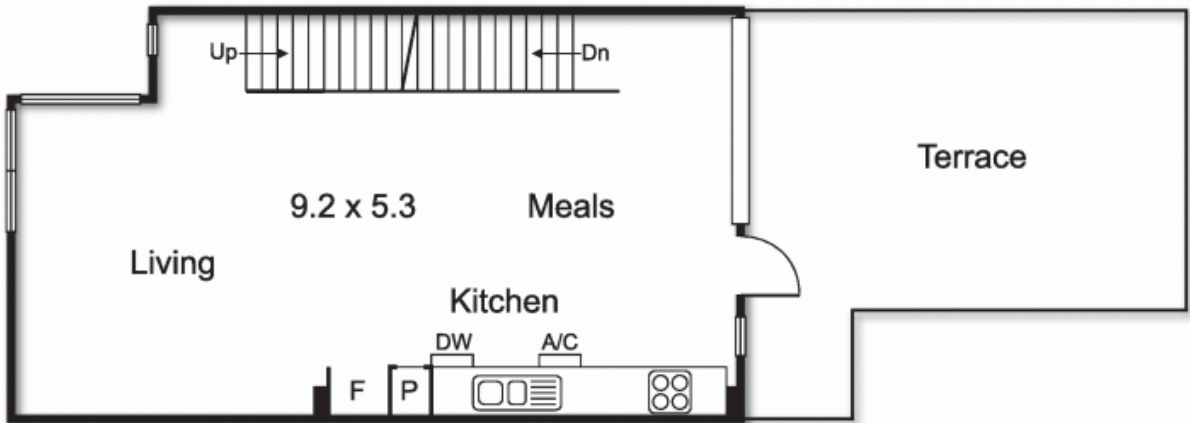

FIRST FLOOR

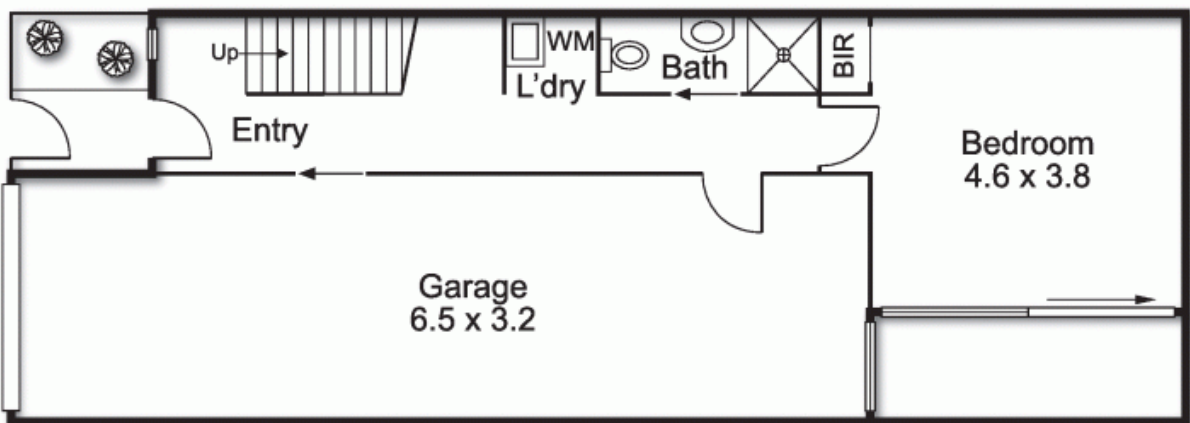

GROUND FLOOR

