



46 Milne Street Templestowe, VIC



3



2



2

Quiet Location with Sweeping Parkland Views!

You can't go past this spacious 3 bedroom family home located in a prime position with sweeping parkland views and all amenities within walking distance. Welcoming you is a spacious living room with adjoining meals area, following through to modern kitchen with stainless steel appliances (gas cooking and Caesar stone benchtops), and adjoining family room, carpeted bedrooms with built-in robes, master with walk-in robe and ensuite, large central bathroom with spa bath. Features include ducted heating, evaporative cooling, ducted vacuum system, remote control double garage and landscaped rear yard with covered verandah, ideal for the entertainer.

Minutes walk to Templestowe Village shopping precinct and cafes, Westerfolds Park walking and bike tracks and picnic areas, nearby Footes Street/Fitzsimons Lane bus services, and schools.

Price: \$550-\$570 PW



Michael Love

0400 106 577

loverealestate@mail.inspectreale

46 Milne Street, Templestowe

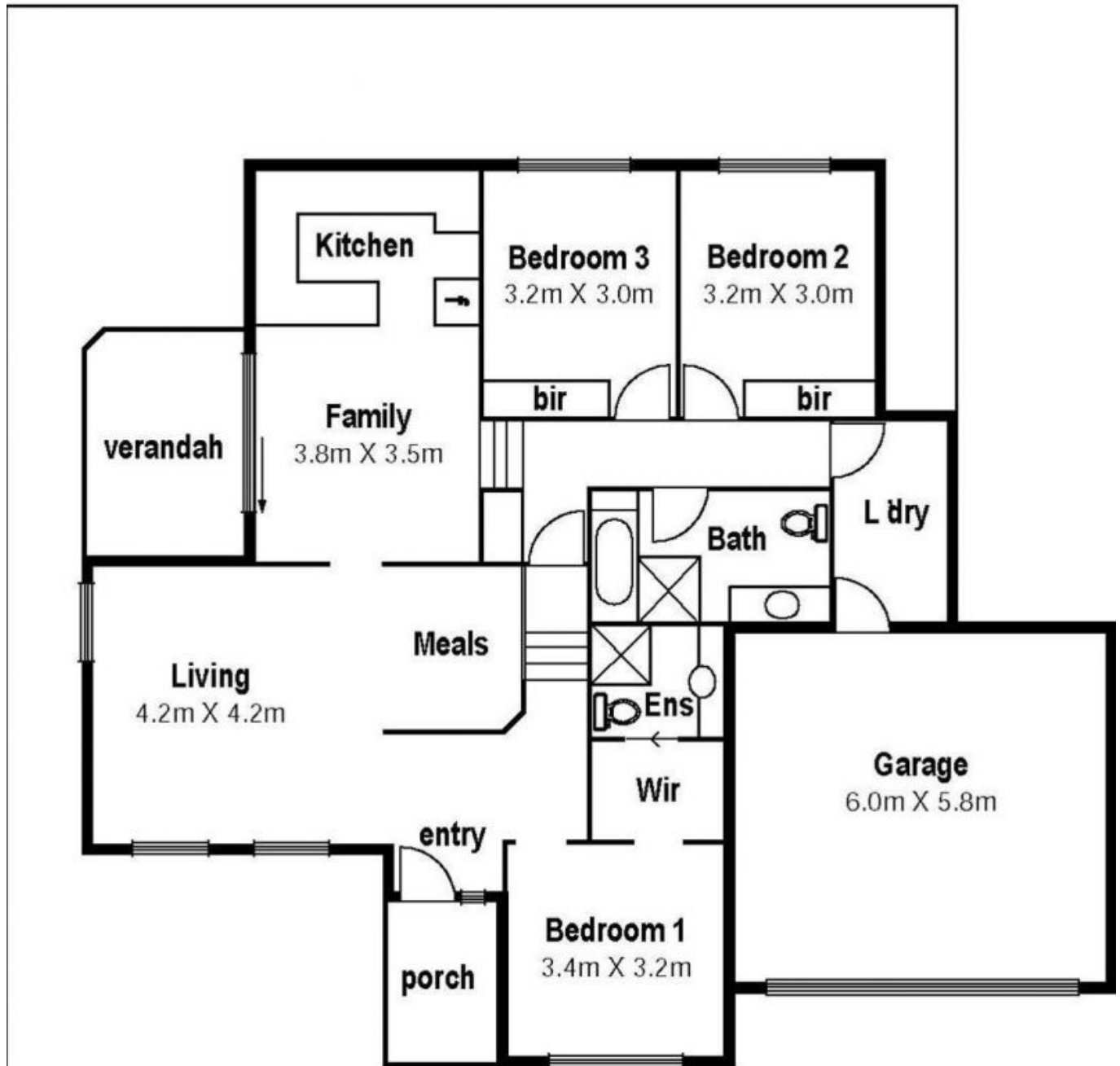

LOVE & CO

46 Milne Street

Templestowe, VIC