

150 Leicester Street FITZROY, VIC
 3  1  1

Close to Brunswick Street Shops, Cafes, Transport & CBD!

Price: \$520 Per Week

APPLICATION PENDING - NO FURTHER INSPECTIONS
 AVAILABLE ON A 6 MONTH LEASE ONLY

This beautiful freestanding Victorian home offers a wonderful blend of comfort, convenience and character. Just moments from the lively Brunswick Street amenities, comprising: entry hall with three good-sized bedrooms, central bathroom with shower-over bath, additional toilet, spacious open-plan living room flowing easily into an equally spacious eat-in kitchen stepping out to nice verandah ideal for entertaining in the balmy summer nights, and separate laundry. Features include: retained period features including Baltic Pine timber flooring, four fireplaces, and car access from a rear laneway. The perfect blend of lifestyle and comfort can be yours so do not miss out! Available to rent from July 17th.



Michael Love

michael.l@lovere.com.au

150 Leicester St. Fitzroy

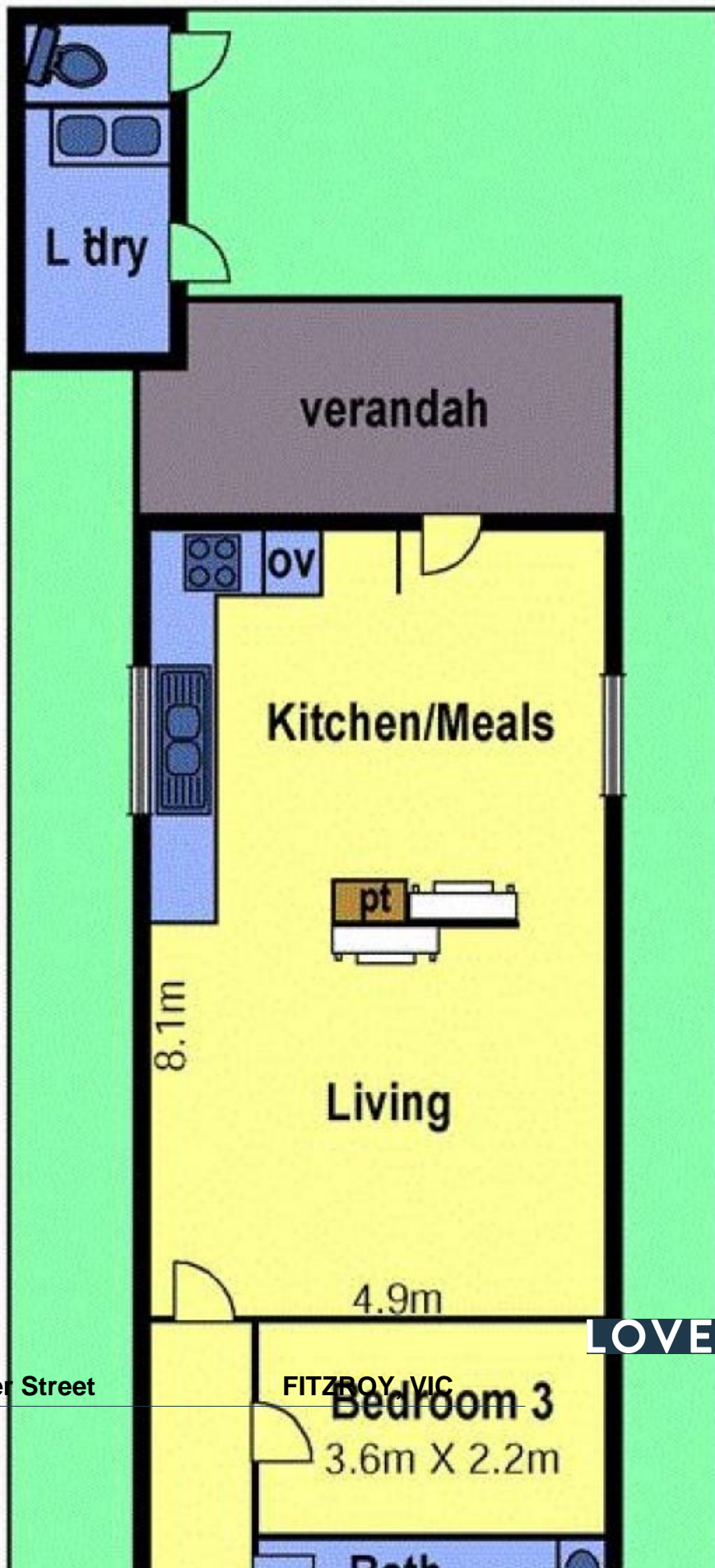

150 Leicester Street

FITZROY, VIC

LOVE & CO