



148 Shaftesbury Parade THORBURY, VIC



2



1

Enduring appeal in an enticing location!

INSPECT THURSDAY 31ST JANUARY 12PM - 12:15PM **UNLESS LEASED PRIOR**

This lovely freestanding home is perfectly presented and offers retro appeal, high ceilings, pictures rails, timber floors, ducted heating and more. Comprising two bedrooms both with built in robes, a spacious living room, retro kitchen, renovated bathroom and beautiful north facing rear yard with storage shed. All this an easy stroll from Merri creek bike path, local golf course, the St Georges Rd tram and the cafs of miller street!

This is the perfect place to call your home so get in quick to make it yours!

Available 26th January.

Bond \$2129

[CN]

Price: \$490 per week



Michael Love

michael.l@lovere.com.au

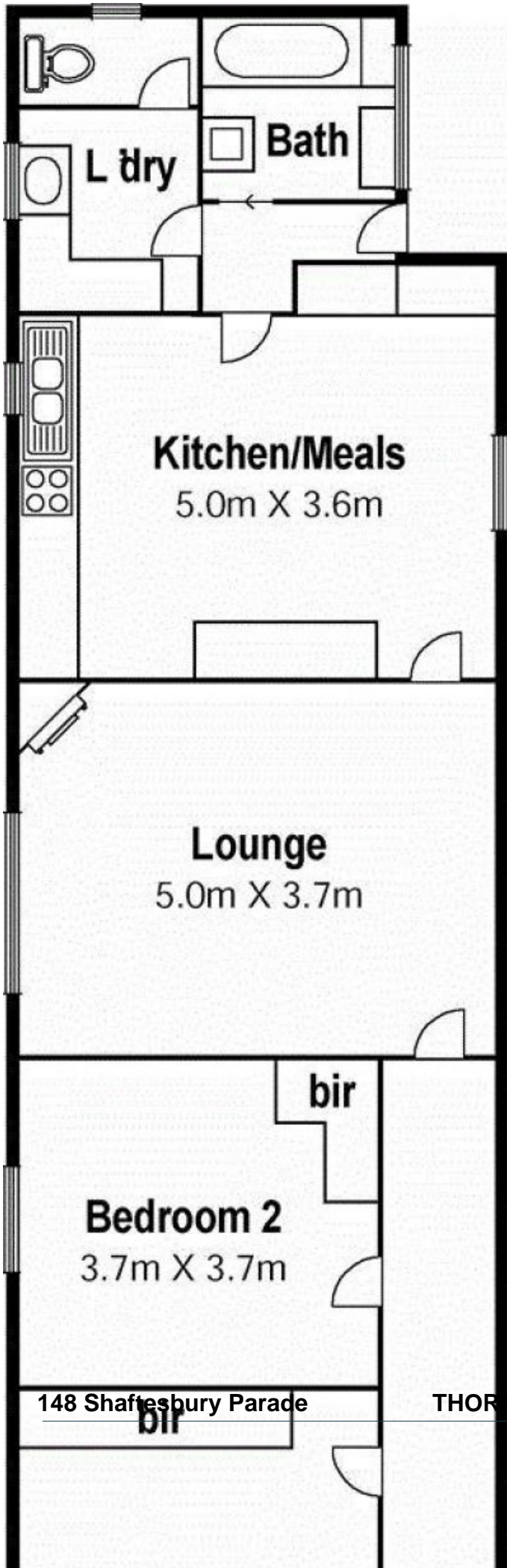

Site Plan

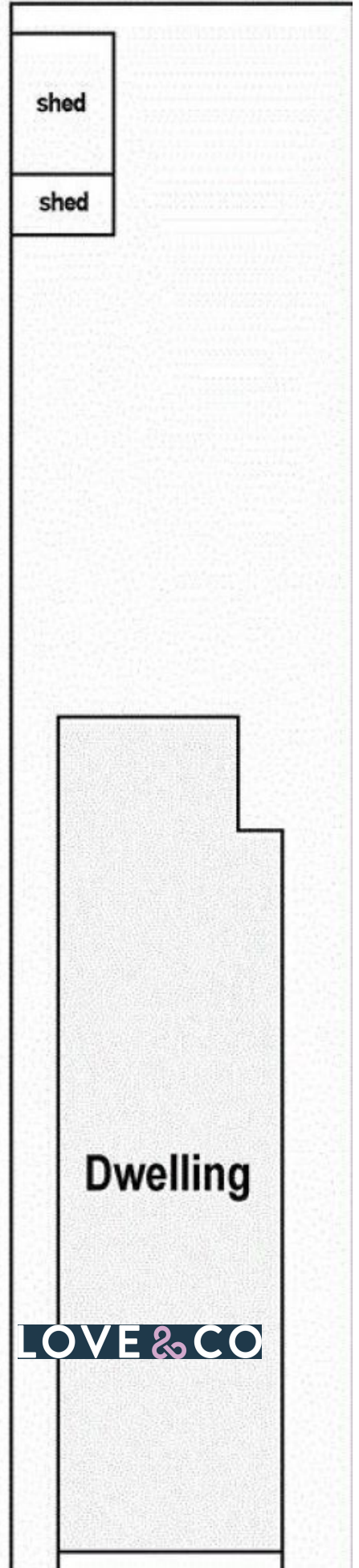

148 Shaftesbury Parade

THORN BURY, VIC