



In conjunction with



VENDOR ADVOCACY AUSTRALIA

vendoradvocacy.com.au



6 Strathford Street Epping, VIC



Effortless Living And Entertaining

Conveniently located within easy proximity of shops, schools and transport, and set behind landscaped gardens that look great, yet require very little maintenance, this family home presents a wonderful opportunity to settle in a sought after pocket.

Recently refreshed with easy care tiles bringing a touch of Tuscany to the "L" shaped living dining and the stunning family bathroom, it introduces a quality fitout including a frameless walk in shower shared by three bedrooms, family meals and an easy to work in kitchen with stainless steel oven.

A paved and decked mix of covered and open outdoor zones delivers plenty of space and ensures hosting family and friends is a real pleasure.

Gas fire heating, cooling, sheds, double carport and enough room to park a caravan or boat are welcome bonuses.



Jim Kalakias

0402 177 336
jim.k@lovere.com.au



Bijan Rahimi

0451 515 301
bijan.r@lovere.com.au

6 Strathford St. Epping

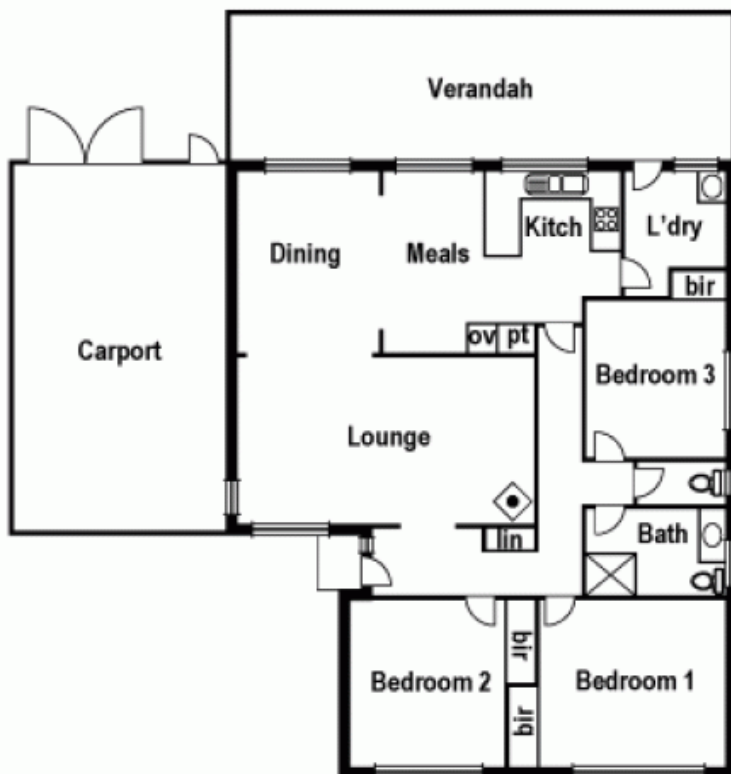

Site Plan

