



28 Saunders Crescent Epping, VIC



4



2



2

Elegance And Excellence / First Time Offered

Showcasing luxury, space and style, this one owner family home delivers an enviable low maintenance lifestyle. Exquisitely presented, it provides family versatility with a choice of formal living dining and a casual living and meals area that wraps around a pristine kitchen with 900 stainless steel range and dual-draw dishwasher.

Both these substantial rooms open to decked entertainment areas, linked by an expansive paved precinct in the no-maintenance rear yard. Indoor and outdoor living is well and truly covered here! Of the bedrooms the main includes an ensuite, while another two share a spotless family bathroom.

A forth bedroom to the front of the house provides an option to work from home if desired. A double garage with rear roller door for trailer parking rounds out fabulous family living, just a short drive or bus trip from the station and Epping Plaza.

Price: \$522,000



Bijan Rahimi

0451 515 301
bijan.r@lovere.com.au



Jim Kalakias

0402 177 336
jim.k@lovere.com.au

28 Saunders Cres. Epping

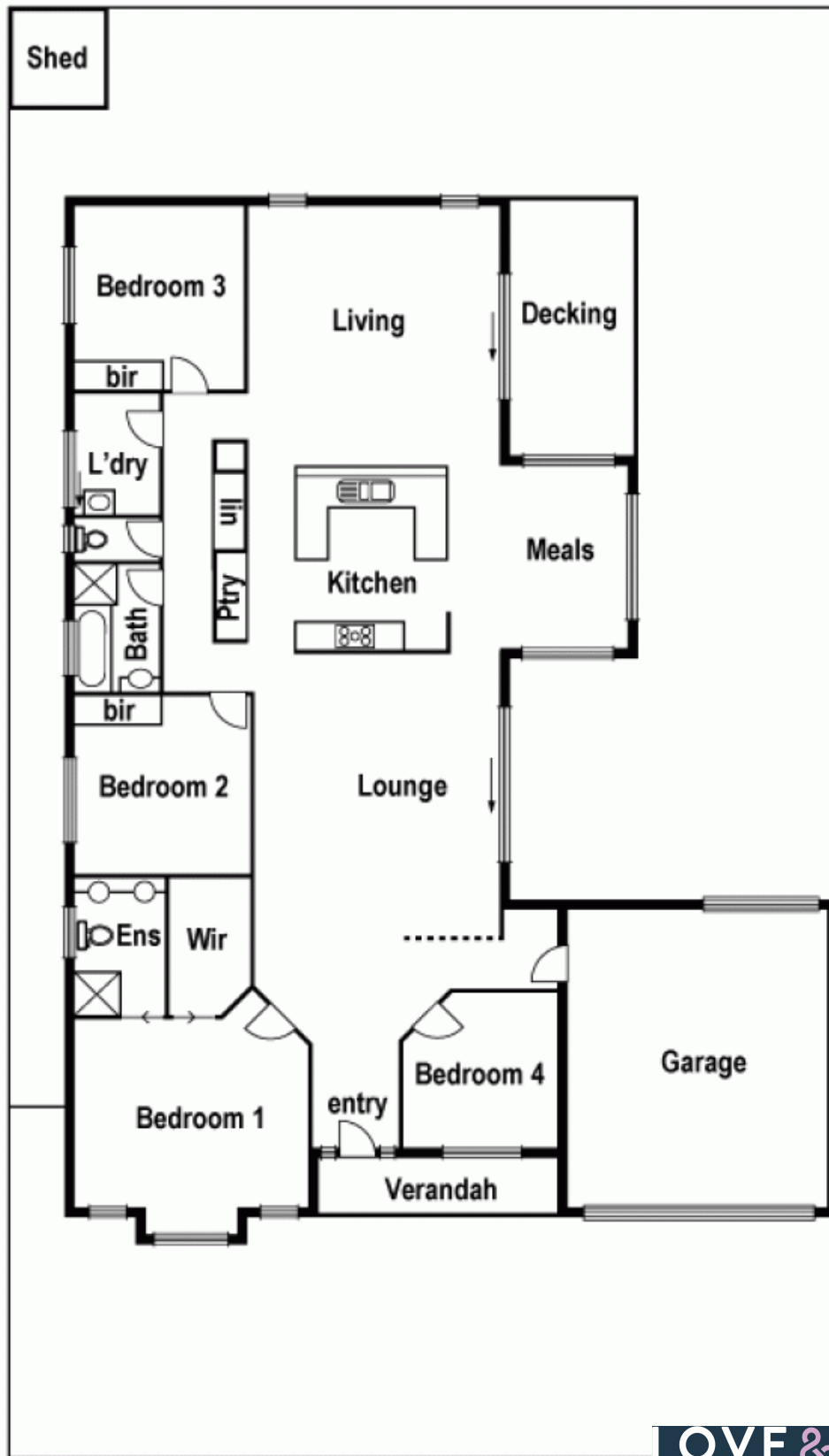

LOVE & CO