



7/213-215 Camp Road Campbellfield, VIC



STYLISH TOWNHOUSE LIVING!

This spacious townhouse offering all the comforts for an enjoyable home within minutes to Sydney Road bus services, Ring Road and Broadmeadows Shopping Centre.

- Tiled downstairs area with separate lounge
- Open plan kitchen meals/family area
- Stainless steel cooking appliances
- Powder room
- Single remote controlled garage.

Upstairs are 2 double bedrooms with built in robes

- Large central bathroom with bath.
- Spacious laundry,
- Gas ducted heating
- Rear courtyard.

Price: \$340-\$360PW



Rachael Wallace

loverealestate@mail.inspectreale

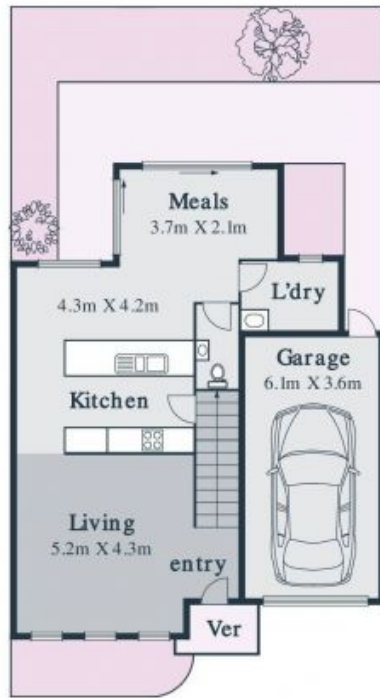

Every precaution has been taken to establish accuracy of the information in this brochure but does not constitute any representation by the vendor or agent