



2/7 Hawthorn Grove Hawthorn, VIC



## AN ADDRESS LIKE NO OTHER

Situated in one of the best tree lined streets in Melbourne and surrounded by stunning period homes you will fall in love with this property before walking in the front door. The main entrance leads to a spacious lounge and living area overlooking the lush green gardens, kitchen with dishwasher and a curved island bench overlooks a private, paved courtyard, a perfect space to entertain, relax and enjoy a low maintenance yet established garden. Upstairs offers two bedrooms with BIRs and wall to ceiling windows, the third bedroom is suitable as a single bedroom or study area and the central bathroom is completed with a European laundry plus a separate toilet. Additional features include alarm system, electric heating, split system heating and cooling, under stairs storage and off street parking for one car space. In an enviable location within walking distance to Glenferrie shopping strip, Glenferrie train station and easy access to the Eastern Freeway this is one not to miss!

**Price:** \$590 per week



**Michael Love**

michael.l@lovere.com.au

# 2/7 Hawthorn Gv. Hawthorn

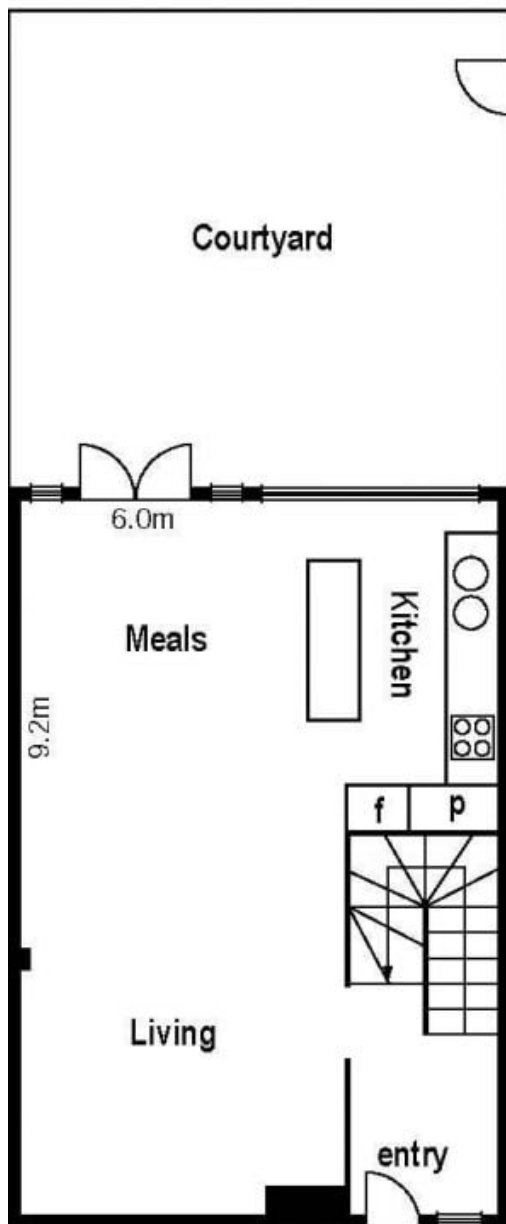

## First Floor

